

USER MANUAL

MIGHTYLIGHT

MODEL 3040



Thank you

for purchasing the MightyLight Solar powered '5 in 1' White LED Lantern.

You are now the proud owner of the latest technology, long life solar lantern that will give you years of high quality performance with daily cost savings.

MightyLight is an independent, reliable and durable light with multiple uses and settings for use in your home and outdoors. MightyLight is safe, pollution free and environment friendly.

Please read this manual before use, for optimal operation and maintenance

INSIDE THE PACKAGE

1	MightyLight
2	Solar Panel with Connector cable
3	Warranty Card

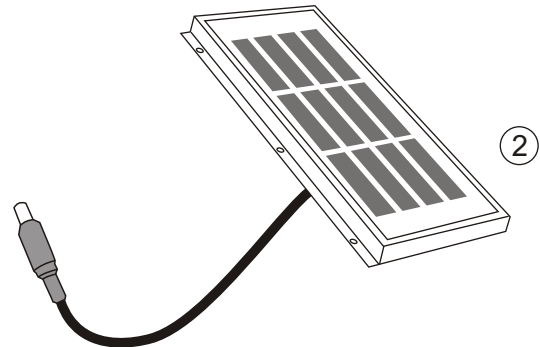
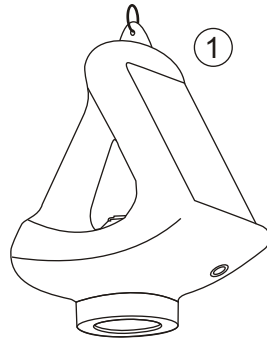

PARTS OF YOUR '5 IN 1' MIGHTYLIGHT

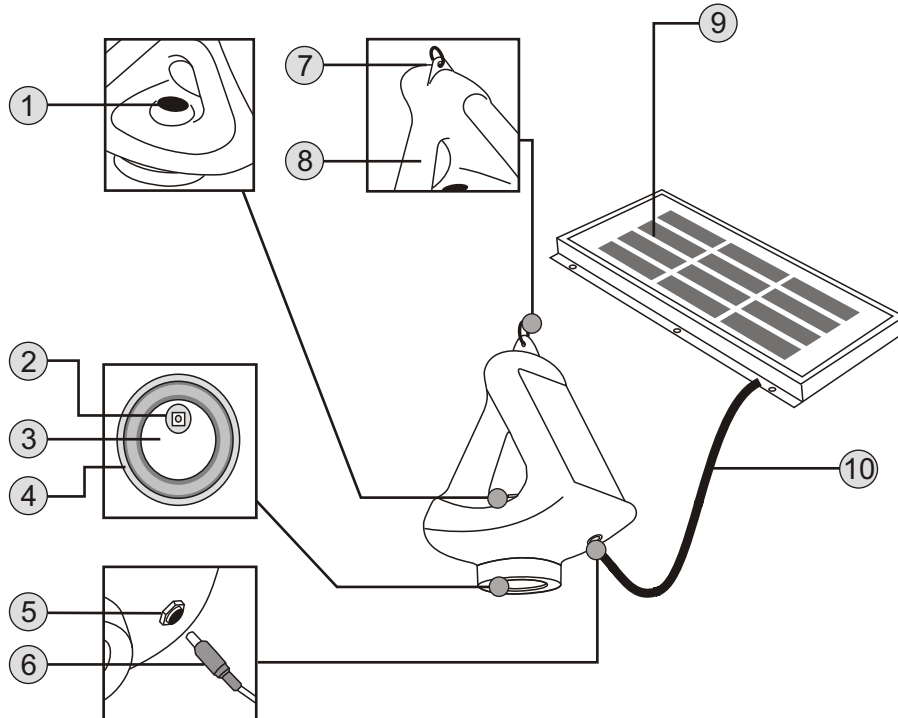

- ① ON/OFF/BRIGHTNESS SETTING
- ② LED LIGHT SOURCE
- ③ LENS
- ④ CAP (FOR LENS ROTATION)
- ⑤ CHARGING CONNECTOR
- ⑥ CHARGING PLUG
- ⑦ HANGING RING
- ⑧ HANDLE
- ⑨ SOLAR PANEL
- ⑩ CHARGING WIRE

USING & OPERATING YOUR '5 IN 1' MIGHTYLIGHT

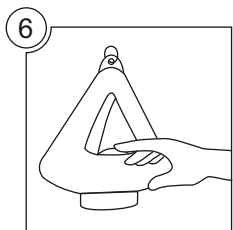
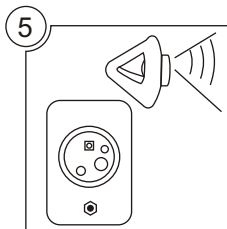
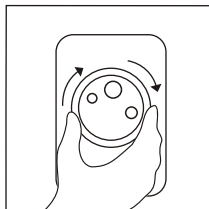
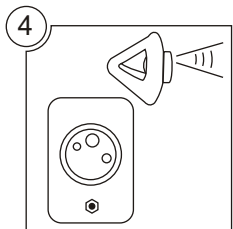
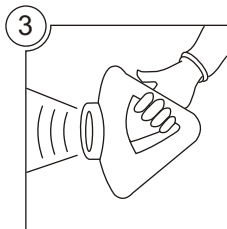
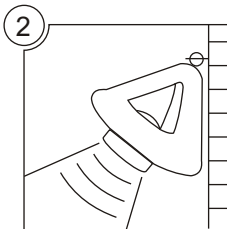
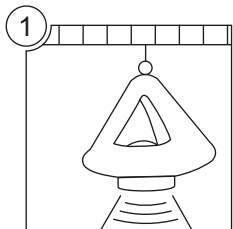

- 1 Ceiling Light:** Hang from the ceiling with 'Hanging Ring'
- 2 Wall Light:** Hang on a wall with 'Hanging Ring' on a nail
- 3 Mobile Light:** Hold the 'Handle' to use as mobile and carry anywhere
- 4 Focus Light:** Position the 'Lens' over the 'LED' by rotating the 'Cap' anticlockwise to have a strong focused light.
- 5 Wide-Angle Light:** Position the 'Lens' away from the 'LED' by rotating the 'Cap' clockwise to have dispersed light.

6 The '5 in 1' MightyLight has 3 modes of Light Brightness

- **All Night Mode:** Press 'On/Off Switch' once to switch on the light in All Night Light mode. Use this setting for long duration.
- **Normal Mode:** Press 'On/Off Switch' twice for Normal light Mode. Use this setting for general lighting.
- **Super Bright Mode:** Press 'On/Off Switch' thrice for Super Bright Light Mode. Use this setting for high brightness.

INSTALLING YOUR SOLAR PANEL

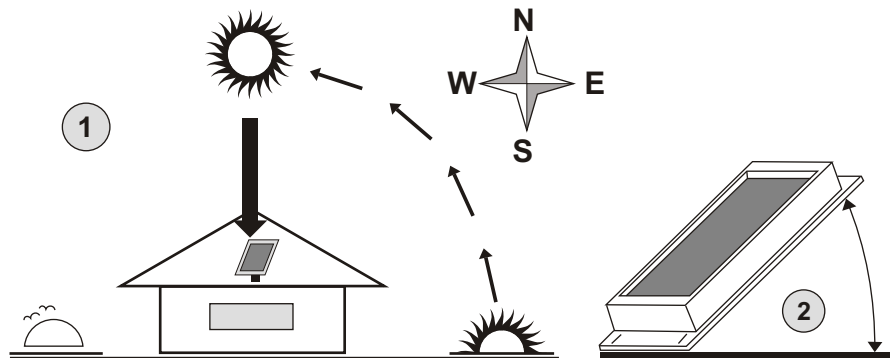

- 1 Mount the Solar Panel securely on your roof or any other sunny place.
- 2 Mount the Solar Panel at an angle -

If you are in the Northern hemisphere:
Mount the Solar Panel facing South
If you are in the Southern hemisphere:
Mount the Solar Panel facing North

Note: Please check for optional angle for your specific country.

CHARGING YOUR '5 IN 1' MIGHTYLIGHT

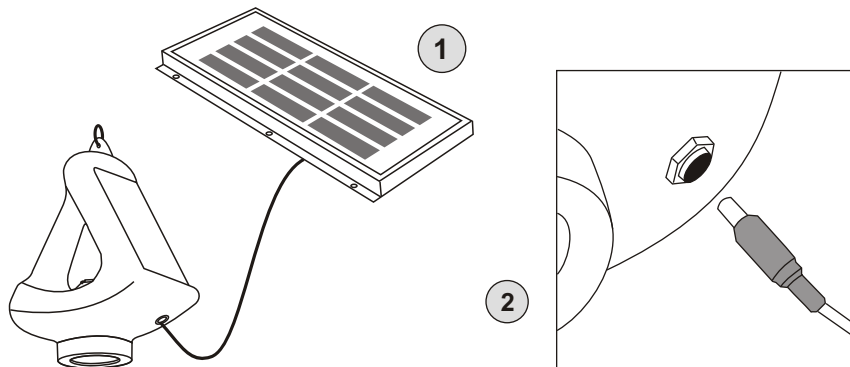

- 1 Connect 'Charging Plug' on the 'Charging Wire' from the 'Solar Panel' to the 'Charging Connector' on the light during the day to charge the light.
- 2 Charge your light for a full day
- 3 Pull out the 'Charging Plug' on the 'Charging Wire' for mobile use and carry the light anywhere.

HOW TO REPLACE BATTERY

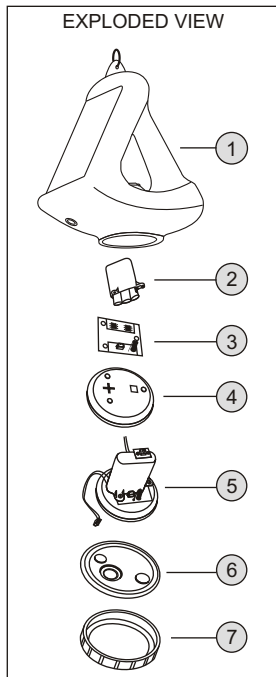

- ① Body
- ② Battery
- ③ PCB
- ④ Reflector plate (Disc)
- ⑤ Assembly of 2-3-4
- ⑥ Lens
- ⑦ Cap

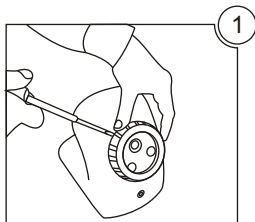

Open the cap with a sharp tool (e.g., screw driver) by putting the sharp edge behind the cap

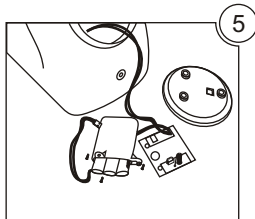

Pull the battery out of the cover

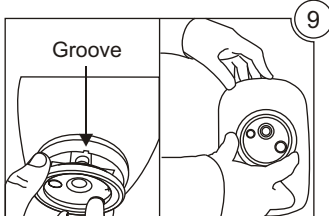

Re-assemble the PCB-disc assembly and lens with LED positioned on top and fit into the body. Note that groove and cut should match as shown

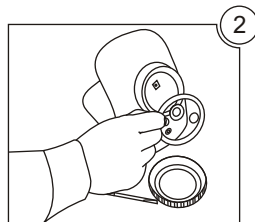

Detach the cap and glass disc from the assembly

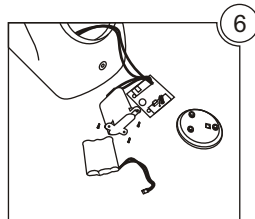

Replace the old battery with new one

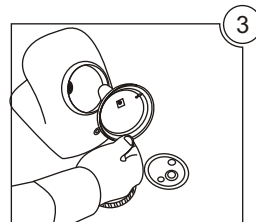

Pull out the reflector, battery and PCB assembly from the body of Mightylight

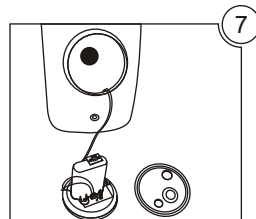

Re-assemble the battery and PCB; then connect the 2 pin connector

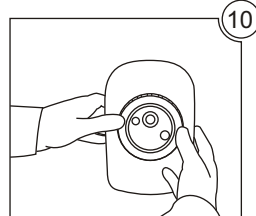

Fit the cap into the body by pressing it uniformly from all sides

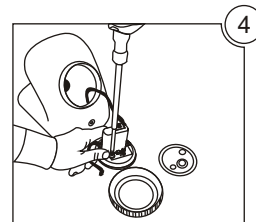

Detach the 2 pin connector of battery from PCB; then detach the battery by unscrewing the PCB and battery assembly

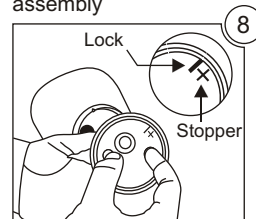

Fit the lens and reflector so that the disc stopper comes below the disc lock

MAINTENANCE

1. MightyLight is durable, reliable, strong and weatherproof.
2. Keep the 'Lens' & 'Solar Panel' clean. Use soft cloth to wipe and prevent scratches.
3. Use only specified re-chargeable batteries when battery change is required. Seek assistance if required.

UNDERSTANDING

Light duration depends on the charging hours and light setting used:

- Light duration is longer when charged on sunny day and less on a cloudy day.
- Light duration is about 3 times longer on All Night mode than on Super Bright mode.
- Light duration is longer when battery is new.
- Light duration is longer when 'Solar Panel' is clean & unscratched.
- Light should be switched off when charging during the day.

TROUBLE SHOOTING

- 1 **Light does not turn on** : Batteries are discharged. Recharge to turn on the light.
- 2 **Light goes off after short time** : Batteries are not fully charged.
 - Check that the light is being properly charged.
 - Check that the Solar Panel is properly installed.
- 3 **Light does not come on even after proper charging** : Batteries need to be changed. Replace with new battery pack.

SPECIFICATION

Weight: 1250 grams / package (approx.)

Components:

Batteries : 3.6V 2000/2100/2300/2500 mAh NiMH Rechargeable
: 24 Months optimal life (depending on usage)

Solar Panel : 2.5W min., 4.75 V

Light Source: 1W White LED lamp

WARRANTY

Cosmos Ignite Innovation Pvt. Ltd. (hereinafter called "Ignite") warrants the product to be free from defects in material in so far as the product is used in normal course, for a period of one year from the date of original purchase when brand new ("warranty period").

- Ignite's sole obligation under this warranty shall be, at its option, to repair or replace the defective part received at its own premises, in the occurrence of any failure or covered under this warranty during the warranty period.
- No warranty is applicable without fully filled in warranty card and proof of purchase.
- Any defective product or part repaired or replaced under the warranty shall be subject to the balance of the original warranty period applying to the product.
- Any defective part replaced under warranty shall become Ignite's property.
- No warranty is applicable on re-chargeable batteries provided.
- Ignite's liability is limited to a maximum of the price at which the product was purchased from Ignite.
- This warranty shall be void if :
 - Failure of the product or part has resulted from service, maintenance or repair other than by Ignite;
 - Product has been altered or obscured;
 - Failure or defect is attributable to any extrinsic cause, accidental damage, improper use, modification, adaptation, neglect, wear and tear, improper installation and connection with any peripheral, external fault.
- Repair or replacement of the product or part is applicable only at Ignite premises:

Cosmos Ignite Innovations Pvt. Ltd.

Vill. Mohamadpur, PO Kherki Daula, Gurgaon - 122004, Haryana, India

(Please pack the product in the original or any safe, solid package and send it by pre-paid mail to Ignite premises as above)